



68 View Road SPRINGVALE

3 1 1

Corner Position, Lucky number 68 View Road

Corner Position, Lucky number 68 View Road

Want to get into Springvale commercial property market, then you must add this property to your new commercial portfolio, current business a milk bar at the front, and 3 bedroom dwelling at rear comprising kitchenette, separate bathroom, secured car space with rear entry.

Rent: \$16,500 incl GST PA

Annual Increase 4% PA

Lease Commencement: 31/01/2014 Term 3 years

Further option 2 x 3 Years

Land size: 6.4m x 33m= 210m2 approx.

Zone: Business Zone1

Auction: Thursday 7/8/2014 on site

Terms: 10% deposit, settlement 30/60 days

Leyton Real Estate

68 View Road, Springvale

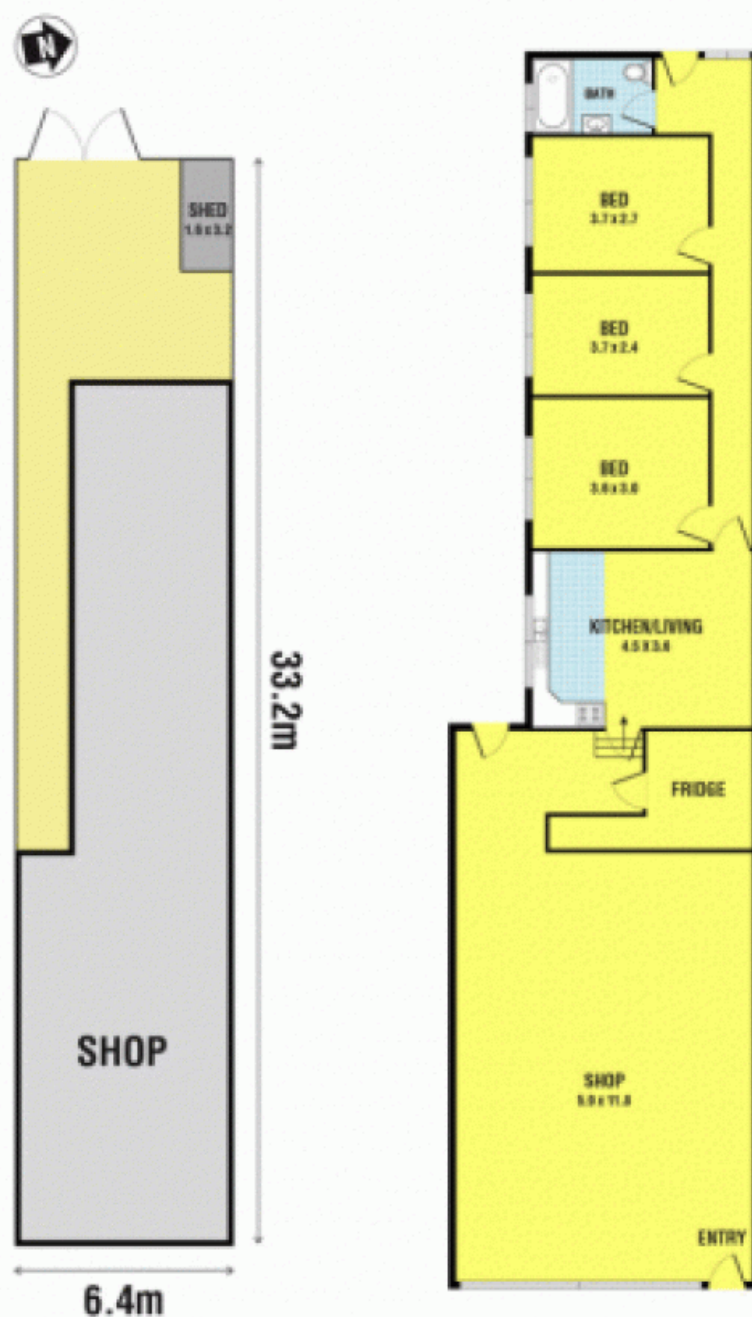

Please note: All stated dimensions are approximate only. Particulars given are for general information only and do not constitute any representation on the part of the vendor or agent.