



2 Parramatta Crescent NOBLE PARK

 4
  2
  2

SOLD IN 1 WEEK BEFORE AUCTION \$458,000

This large family home set on a corner block and is located on the high demand pocket of Noble Park and close to all conveniences: Kingsclere Shopping Centre is right at your front door, bus stops, walking distance to Wallarano Primary School, short drive to Parkmore Shopping Centre, easy access to Eastlink and Dandenong by pass.

Featuring: L shape lounge room, 2 large bedrooms upstairs with FES and WIR to master bedroom, downstairs 2 bedrooms with all BIR, updated main bathroom, separate toilet, updated kitchen with S/S cook top, auto double car carport, 2 X water tanks 3000L, roller shutter to windows upstairs, all gas appliances, under covered decking area, rear veranda, lovely front landscape.

Keep your family cool and comfortable year round with A/C, ducted evaporative cooling and ducted heating. Simply move in and enjoy all this and more!

Bring your family to check it out.

Land size: 580 M2 approx.

Terms: 10% deposit

Balance: 30/60 days



Thu Le

0421 903 814

2 Parramatta Crescent, Noble Park



FIRST FLOOR



GROUND FLOOR

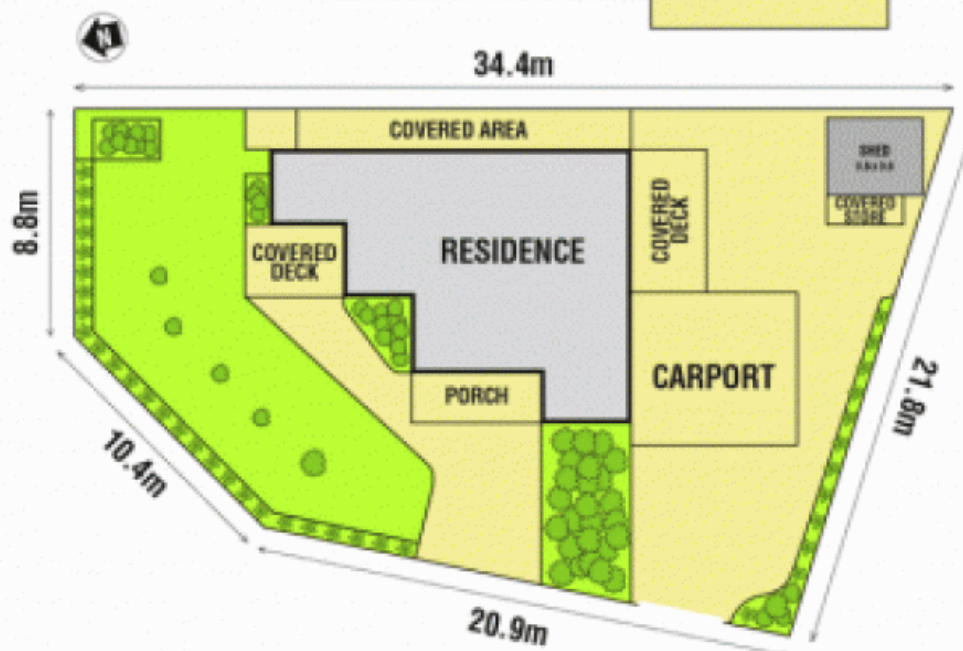

Please note: All stated dimensions are approximate only. Particulars given are for general information only and do not constitute any representation on the part of the vendor or agent.