



52-54 Gray Street SPRINGVALE

 3  2  2

Rare Springvale Gem - (1,585m2 approx.) - Sold at Auction

Rare Springvale Gem - (1,585m2 approx.)

For the first time on offer is a perfect opportunity for astute investors and developers alike. This great estate held within 1 family comprised of two separate titles and total land area of 1,585m2 (approx.), positioned atop the Springvale Hill with a northern aspect in a quiet neighbourhood, yet within walking distances to local shopping including Coles, local bakeries and cafes.

Extremely well built and maintained, this extra large home offers 3 generous bedrooms all with BIRs, 2 bathrooms, 3 toilets, massive family room with large bay windows, study area including built in book case opening to the alfresco, remote control garage, carport and workshop space.

Prime real estate in the ever so desirable locale of Springvale and with so many options to further capitalise. Put this one on top of your must see list!

Auction: Saturday, 12 November at 11:30am on Site

Leyton Real Estate

52-54 Gray Street, SPRINGVALE

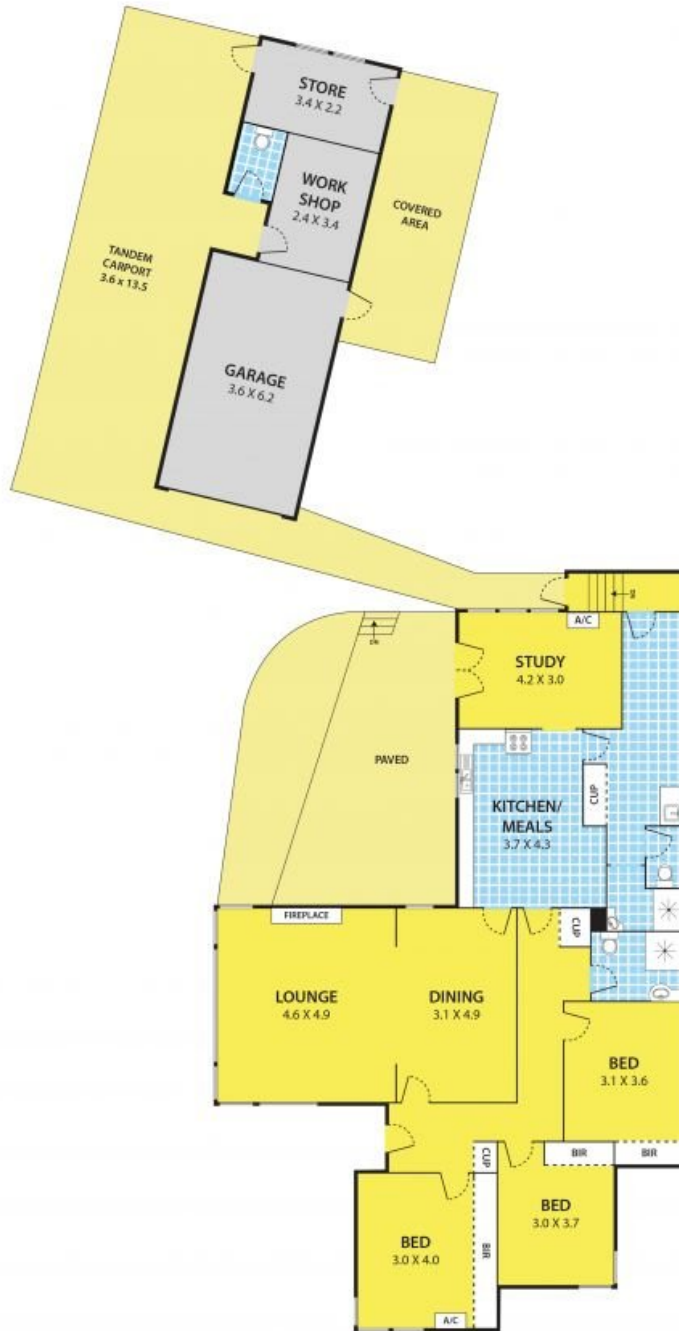

DISCLAIMER:

Please note plans are indicative only and not drawn to exact scale.
All dimensions are approximate