



43 Wareham Street SPRINGVALE

 3  1  5

On Top of the Hill

Positioned atop the Springvale Hill on a 735sqm (approx.) allotment. This charming family home is right across from Springvale Rise Primary School, minutes' walk to bus stops, Coles Supermarket, local bakeries, cafes, restaurants and a short drive to Springvale Central and Springvale Train Station.

Since new, this well built and well maintained family home has only ever had one owner, its near immaculate condition reflects and demonstrates the families love and care over the years. Comprising of: 3 extra-large bedrooms + a study den, main bathroom with a corner spa, a bidet, 2 toilets, solid timber kitchen with gas appliances, incinerator and dishwasher, separate meals area, large formal lounge opening to the front balcony that on a clear day, offers views towards Mount Martha and a large rear veranda decking overlooking the spacious backyard with plenty of fruit trees for your family to enjoy. Adding to this list you additionally have an over-sized remote 3 car garage (6.0m x 9.9m) and work space, elevated front patio, ducted heating and cooling, split A/C in the formal lounge, 6 green energy saving solar panels and a large water tank for the garden.

Leyton Real Estate

43 Wareham Street, SPRINGVALE



DOWNSTAIRS

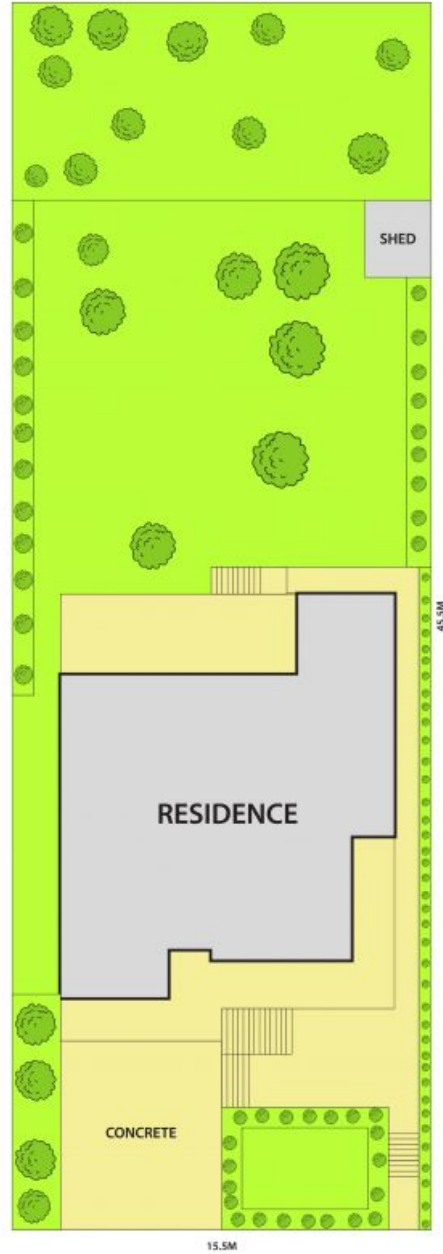
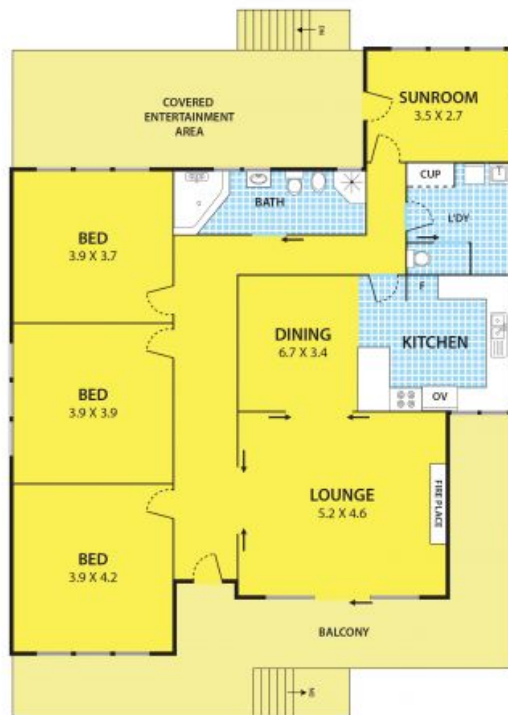

DISCLAIMER:

Please note plans are indicative only and not drawn to exact scale.
All dimensions are approximate