



5 Blanford Court MULGRAVE

3 2 2

### Modern Family Living in the Waverley Park Estate

This contemporarily designed and well maintained double-storey residence is ready for one lucky family to move in and enjoy or to lease out!

Located in a quiet and leafy Cul De Sac in one of the most desirable pockets of Mulgrave, where you and your family can enjoy the many amenities that this peaceful estate offers, in addition to the oval, gym, cafe, shops, local parks and reserves that are only short strolls away. Only minutes' drive to Waverley Garden Shopping centre, Primary and Secondary Schools, easy access to Wellington Road and both M1 and M3.

Offering: 3 good sized bedrooms with BIRs and master with FES, open plan kitchen with gas cooking and island stone bench, open plan living area opening to a spacious sunroom that can be used as a rumpus or study area, powder room, a main bathroom with toilet, ducted heating system and 4 split A/Cs throughout for absolute comfort, downlights and double sized LU remote garage with internal access. Stepping outside, you will have your very own courtyard with generous undercover area for both relaxation and entertainment!

**Leyton Real Estate**

5 Blanford Court, MULGRAVE

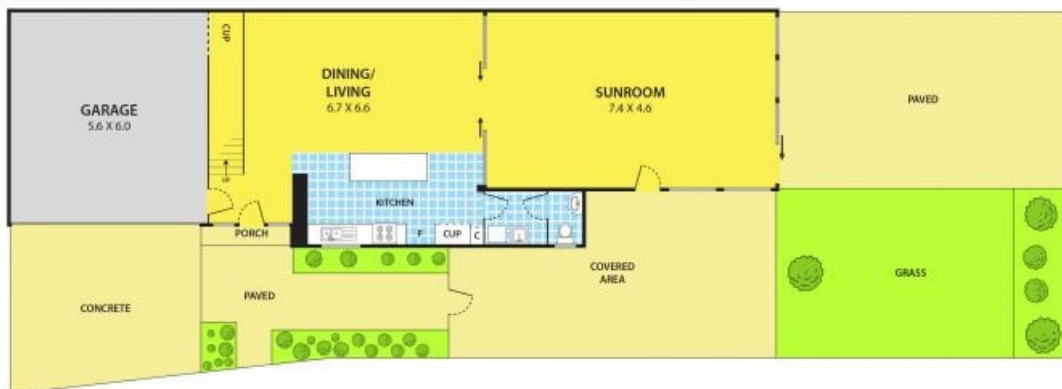
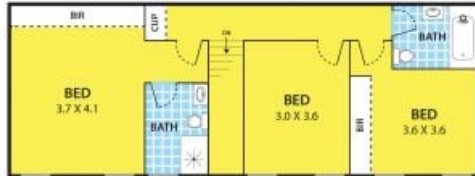

DISCLAIMER:

Please note plans are indicative only and not drawn to exact scale.  
All dimensions are approximate