



2/10 Dodds Street SPRINGVALE

3 1 1

Family Friendly Living in a Convenient Location!

This well-kept rear BV residence in Springvale is ready for you and your family to move in or to lease out! Sitting on approx. 320sqm land in one of the most popular pockets of Springvale Central, just a few doors away is Heatherhill Primary School and all the amenities are within walking distances, including Shops, Killester and Keysborough College, Library, bus stops and Train Station.

This North facing family home offers: 3 good sized bedrooms with BIRs, welcoming lounge with an A/C, well-appointed kitchen with gas cooking, updated bathroom and toilets and ducted heating for your comfort. Stepping outside is a generous undercover area for your relaxation and entertainment, a LU garage with internal access via your own driveway and NO BODY CORP!

Contact Phuc Le or Jun Lee today!

Photo ID Required for all inspections

Leyton Real Estate

2/10 Dodds Street, SPRINGVALE

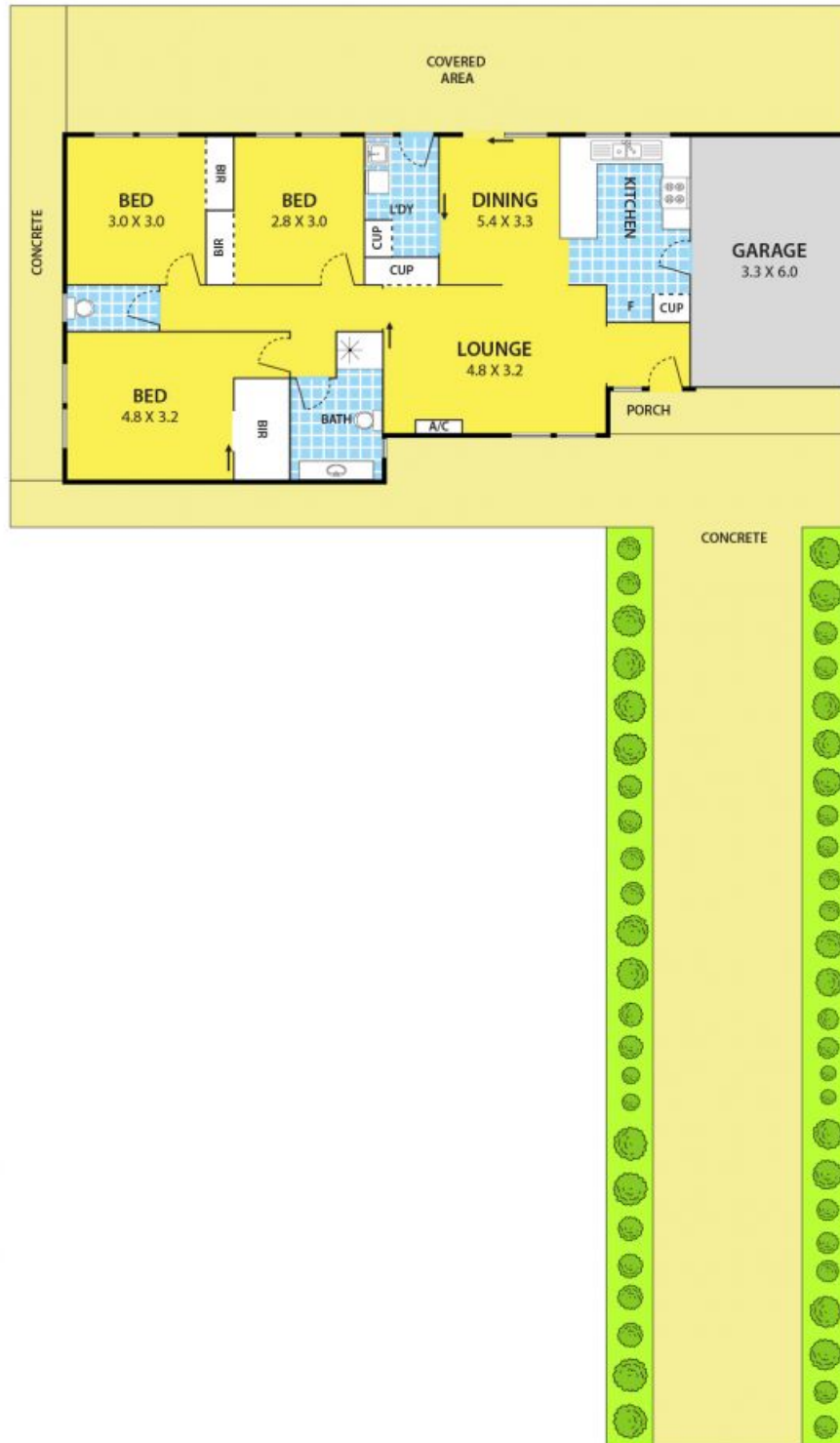

DISCLAIMER:

Please note plans are indicative only and not drawn to exact scale.
All dimensions are approximate