



20/27-29 Golden Grove SPRINGVALE SOUTH

3 2 1

Contemporary Lifestyle in Golden Location!

Convenient living in the right location for you and your family? This well maintained home in the one of the most desirable pockets in Springvale South is ready for you and your family to move in or to let out.

Peacefully located in leafy and family friendly court with a bus stop only a few steps away and Schools, local parks and reserves within short strolls. A little bit further, you are only within minutes' drive to famous Springvale Central and Train Station and Parkmore Shopping Centre. Easy access to Westall and Springvale Roads and Dandenong Bypass.

Featuring: 3 spacious bedrooms, all with mirrored BIRs and master bedroom with FES, large lounge area opening up to your very own and sunny balcony. Open planned S/S kitchen including stone island bench, induction system, dishwasher, corner pantry and adjoining meals area. Updated bathroom with separated toilet and European laundry. DeLonghi split reverse A/C, LED downlights throughout, intercom system and plenty of storage spaces. Additionally you have your own allocated carport and visitors car park on ground floor!

This light and bright home offers an ideal contemporary lifestyle

Leyton Real Estate

20/27-29 Golden Grove, SPRINGVALE SOUTH

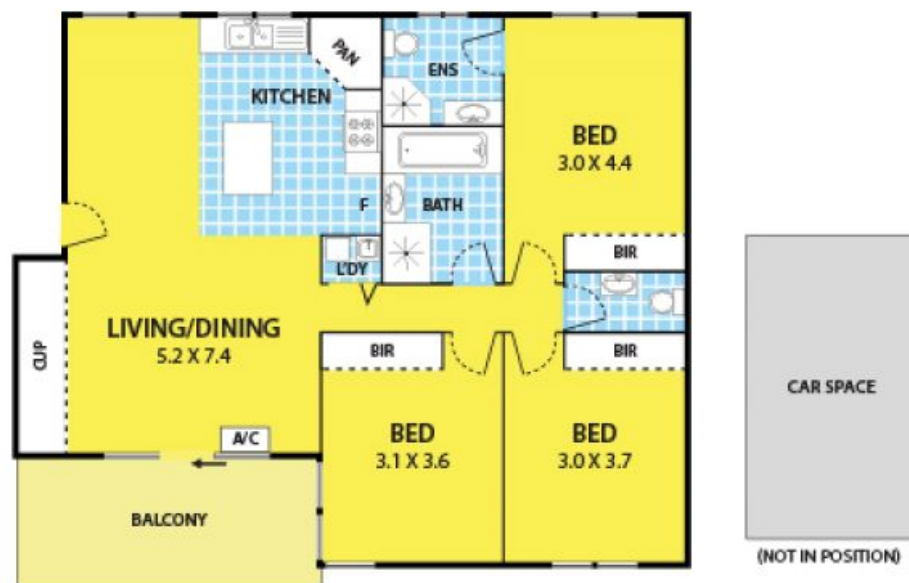

DISCLAIMER:

Please note plans are indicative only and not drawn to exact scale.
All dimensions are approximate