

3/2 Moya Crescent NOBLE PARK

 2
  1
  1

Fantastic Location

Whether you're a first home buyer, downsizer or looking to add to your property portfolio, this charming brick veneer unit offers all the essential features and amenities that the growing Noble Park has to offer.

Conveniently located less than 800m from Noble Park Train Station and Noble Park Central, offering a variety of conveniences including: banks, restaurants, local retailers, Noble Park Aquatic Centre, local skate parks and Coles Supermarket.

Comprising of:

- 2 Bedrooms with BIRs
- 1 Bathroom and separate toilet
- Split A/C
- Ducted Heating
- Single Garage
- Low maintenance private backyard

PLEASE NOTE:

- All enquiries MUST include a contact telephone number
- Photo ID Required for all Inspections

Leyton Real Estate

3/2 Moya Crescent, NOBLE PARK

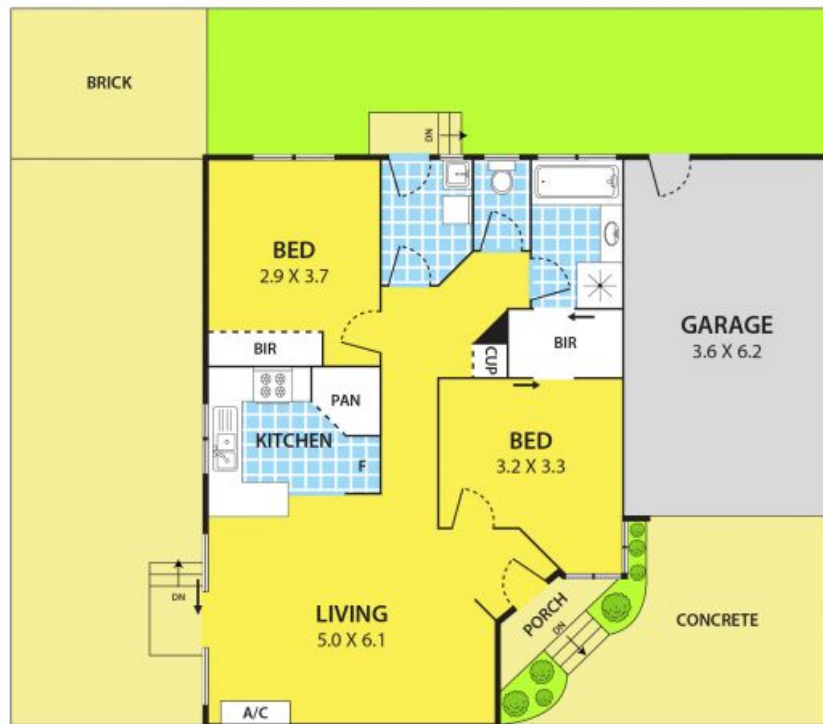

DISCLAIMER:

Please note plans are indicative only and not drawn to exact scale.
All dimensions are approximate