

leyton



33 Whitworth Avenue SPRINGVALE

 4  2  1

SOLD at Auction for Record Price!

YOUR DREAM HOME IS HERE!:

This immaculately presented rendered BV home with high ceilings is set on a large rectangular allotment of 705m² (approx.), in a Residential Zone 1, further development is possible (STCA)!

Walking distance to all conveniences such as: Medical clinics, Minaret School, Public Transportations and easy access to Coles shopping district, train Station and vibrant Springvale Shopping Centre.

Highlighted Features include:

4 good size bedrooms, master bedroom with FES and WIR, BIRs to the rest, spacious L shape lounge room, kitchen adjoining to meals area and family room, updated kitchen and bathroom, dishwasher, all gas appliances, ducted heating, AC, a large and open backyard, a single garage plus workshop and so much more...

Whether you are a home buyer or investor, this is an opportunity not to be missed!

Put this one on top of your inspection list! Must see it now!



Thu Le

0421 903 814

33 Whitworth Avenue, SPRINGVALE

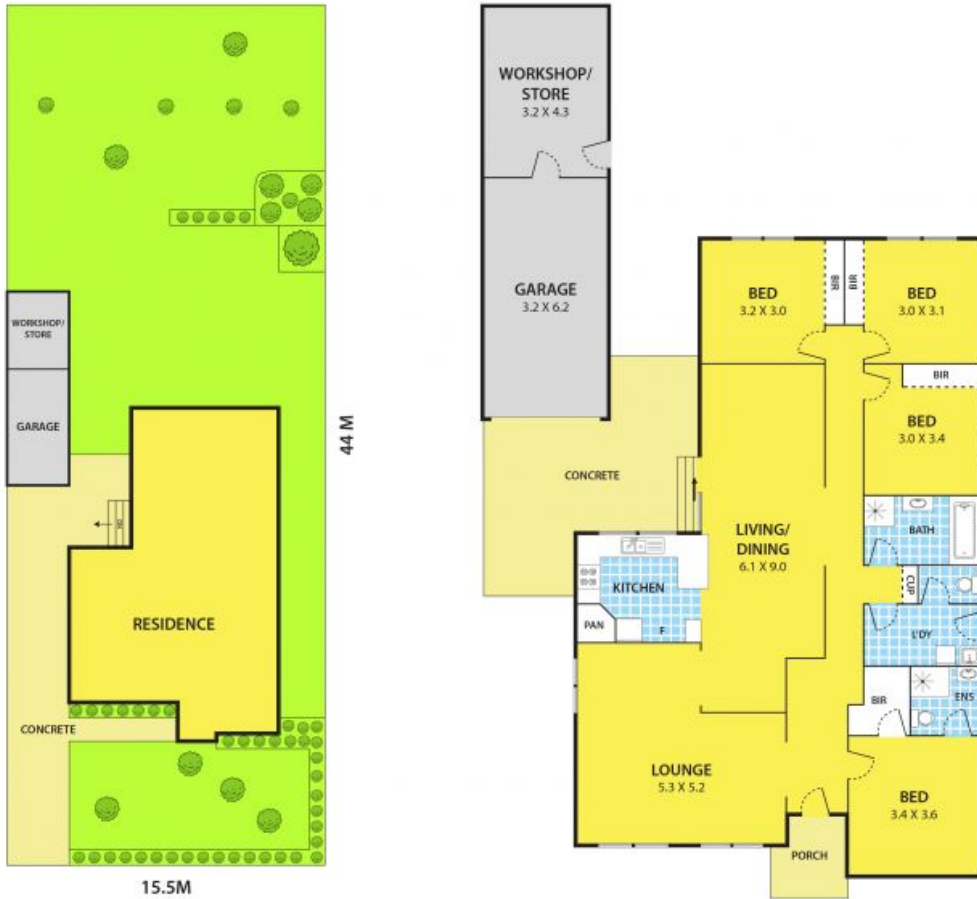

DISCLAIMER:

Please note plans are indicative only and not drawn to exact scale.
All dimensions are approximate