

leyton



1/927 Heatherton Road SPRINGVALE

 3
  1
  3

## LOCATION, LOCATION. SAY NO MORE!!

Situated in this much sought after location with beautiful Burden Park right opposite. Walking distance to Keysborough College and Heatherhill Primary School, bus stops at your doorstep and only just minutes drive to vibrant Springvale Shopping Central. This airy modern townhouse with an open-plan living and 3 spacious bedrooms and an extra-large single car garage with remote control that offers plenty of storage space, is ideal for first home buyers, investors or a young family looking to get into the property market!!

Property features include an open-plan kitchen with a gas stainless steel cooktop, dishwasher, dining and lounge, a generous sized bedroom downstairs overlooking a lovely small courtyard, as well as a separate laundry and toilet. Upstairs there are two additional bedrooms with built-in robes, a central bathroom with separate bath and shower and another separate toilet just for your convenience.

Whether you are looking to invest or looking for a home that you can make own, then you need not look any further. Contact me today to arrange an inspection!

Leyton Real Estate

# 1/927 Heatherton Road, SPRINGVALE



GROUND FLOOR

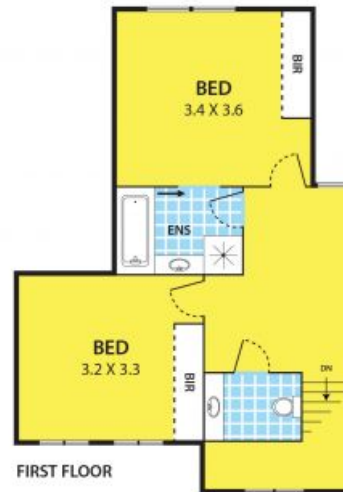

FIRST FLOOR



**DISCLAIMER:**

Please note plans are indicative only and not drawn to exact scale.  
All dimensions are approximate