



731 Princes Highway SPRINGVALE

3 1 4

### A Vibrant Family Future or Investment Opportunity!

An exciting location to start your family home or to build your investment portfolio! This original 1970s blonde brick home provides direct access to Princes Hwy, Monash University, Melbourne City and Bus Stop right at hand. Local schools include Springvale Heights and St John Vianneys Primary Schools and Wellington Secondary College, Coles Shopping Complex, Bunnings Warehouse and Springvale Homemaker Centre are all a short drive away and new Aldi store will open soon on the corner of Princes Hwy and Smith Rd.

Easy access to popular districts for your grocery shopping or family dine-in such as Springvale Central, The Glen or Clayton Central Strip. Coming soon near you is M-City, the most anticipated development in the South East corridor, just located along Princes Hwy, with talks of being a K-Mart, Woolworths and cinema complex, providing your family with plenty of outside entertainment!

Sitting on approx. 585m2 freshly painted and with a chance for future development (STCA), the residence comprises of 3 bedrooms, standalone wardrobes in 2 bedrooms, a sunlit lounge with inverter A/C separate from the rooms,



**Thu Le**

0421 903 814

# 731 Princes Highway, SPRINGVALE

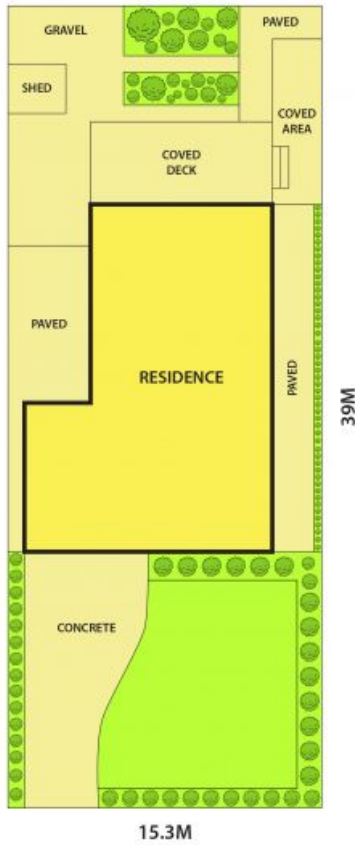

15.3M



DISCLAIMER:

Please note plans are indicative only and not drawn to exact scale.  
All dimensions are approximate