

leyton



2/15 Third Street CLAYTON SOUTH

 4
  2
  2

Modern Family Lifestyle in Convenient Location

Only two on the block, nestled in a high demand street is this 4 bedroom town home just over 1 year young. Scaled for the fast pace lifestyle or for one lucky family to appreciate and enjoy. Walking distance to Westall Train Station, First Street Reserve, Westall Secondary College and Westall Primary School, minutes' drive to Monash Medical Centre, Medical Clinics, Clayton Train Station, Monash University, Clayton Shopping Centre and mouth-watering restaurants, bus stops and so much more that are right at hand.

This home is flawlessly defined with timber hardwood floorboards flowing seamlessly throughout the home, with dining and lounge areas opening to beautiful green garden, a modern kitchen with granite bench top, glass splash back, tu-pac kitchen with soft close draws, dishwasher and Blanco appliances. Master bedroom is located downstairs including FES and WIR, other three bedrooms located upstairs, all with BIRs and Split A/Cs, central bathroom detailed with tiles to the ceiling and stone bench. Other features include: a total of 5 X Split A/Cs, one in the lounge and other 4 in the bedrooms, 2.7m high ceiling downstairs, powder and laundry rooms, tiles to wet areas, LED downlights all around, double glazed windows and internal access from remote controlled double garage.



Thu Le

0421 903 814

2/15 Third Street, CLAYTON SOUTH



GROUND FLOOR

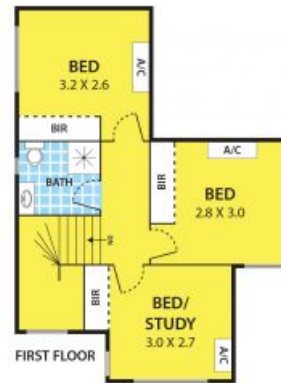

DISCLAIMER:

Please note plans are indicative only and not drawn to exact scale.
All dimensions are approximate