

leyton



13/2-22 Breanne Place KEYSBOROUGH

3 2 2

Start Your Family Here!

A lifestyle of effortless living with enduring quality, this modern and low maintenance street frontage town residence is ready for you and your family to move in and enjoy or to lease out straight away!

Located in one of the most desirable pockets in The Key Estate, right opposite is Ralphie's Park for you to enjoy, Lighthouse Christian College is just a few doors down and Garden World, bus stops and Haileybury College are all within walking distances. Enjoy the Parks and Recreation that Keysborough has to offer with Springers Leisure Centre, Tatterson Park, Maurie Jarvis Woodland for a weekend BBQ and Keysborough Golf Clubs are all close by as well. Shop at Parkmore Shopping Centre or Keysborough South Shopping Centre with Woolworth newly open. Edithvale beach just a 10 minute drive away. Bunnings, Costco and DFO are also not too far away. Easy access to Springvale Road, Westall Extension Freeway, Dandenong Bypass and EastLink.

Featuring high quality finishes throughout: a formal lounge room, 3 bedrooms, all with BIRs, spacious master with FES, plenty of natural lighting for the family with skylights in 2 bedrooms and an auto skylight in the other. Third bedroom opens to a balcony and faces towards the proposed Communal BBQ



Thu Le

0421 903 814

13/2-22 Breanne Place, KEYSBOROUGH

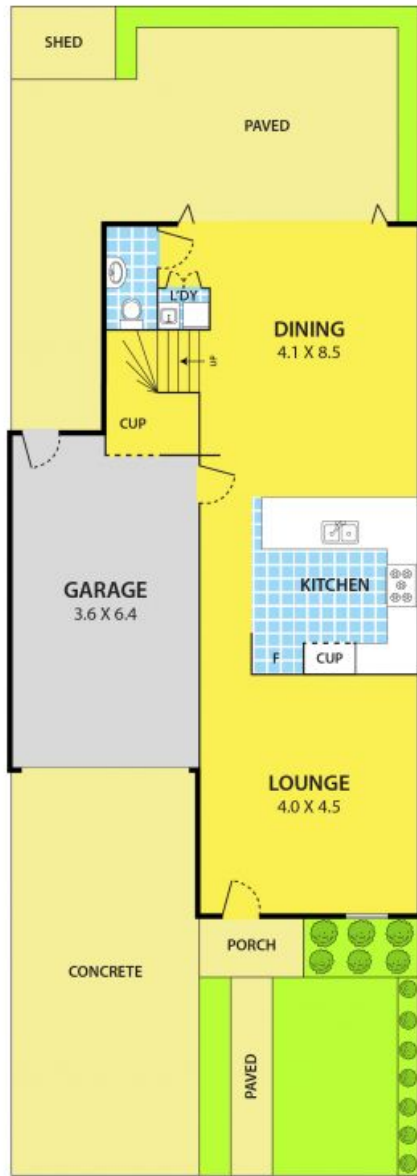

GROUND FLOOR

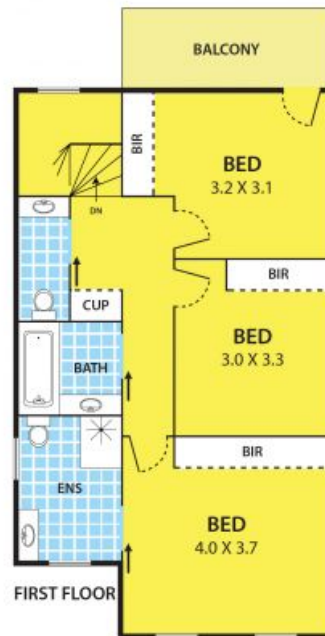

DISCLAIMER:

Please note plans are indicative only and not drawn to exact scale.
All dimensions are approximate