

leyton



12 Flowervale Road NOBLE PARK

 3
  1
  3

Classic Veneer on Approx. 665m²

This great sized home serves as a perfect platform to start your family here! Safe and secure and best of all sitting on approx. 665m² (16.76m X 39.39m) with potential of further sub-division (STCA).

Located deep in a cul-de-sac just off artery Corrigan Road giving ease of access to Parkmore Shopping Centre or Princess Hwy. Close to schools such as Keysborough College, Heatherhill Primary School and Resurrection Primary School just to name a few, bus stops just located on Corrigan Road or choose to drive only minutes' away from Athol Shops and Springvale Central.

Property Features:

- 3 bedrooms, BIRs in two
- Central Bathroom
- Spacious North Lounge
- Kitchen with breakfast bench
- Large family entertainment area open to undercover decking
- Ducted heating, split A/C x 1
- Single remote garage with roller access to back
- Workshop
- Floorboards



Thu Le

0421 903 814

12 Flowervale Road, NOBLE PARK

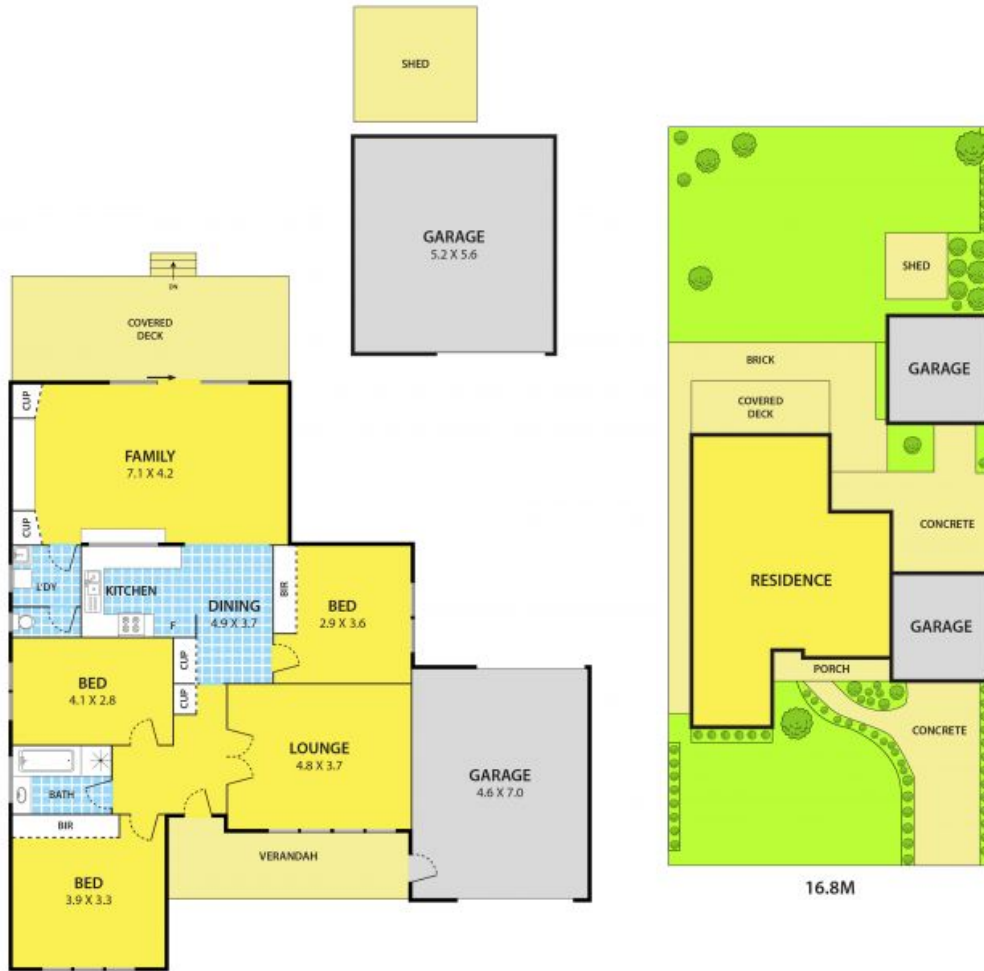

DISCLAIMER:

Please note plans are indicative only and not drawn to exact scale.
All dimensions are approximate