

4/816-822 Heatherton Road SPRINGVALE SOUTH

 2
  1
  1

## You little beauty!

Fantastic entry into Springvale South market. Situated in a top location walking distances to Aldi shopping center, also minutes from local primary schools and secondary college. Minutes away from Dingley By-pass.

Spacious group of boutique units with plenty of open spaces and abundant guest parking.

Have been updated in the last few years, 2 bedrooms both with BIR. Updated functional kitchen adjoining meals area.

Modern bathroom with separate toilet, large lounge with split A/C and polished floorboards throughout.

Whether you are looking as a first home or as an investment, you simply cannot overlook such fantastic opportunity.

Bus Route right at hand 811 & 814

Potential lease: \$1,380 PCM

Strata Fees Approx: \$225 per quarter

Contact Thu Le or Jeffery Fung for more information.



**Thu Le**

0421 903 814

## 4/816-822 Heatherton Road, SPRINGVALE SOUTH

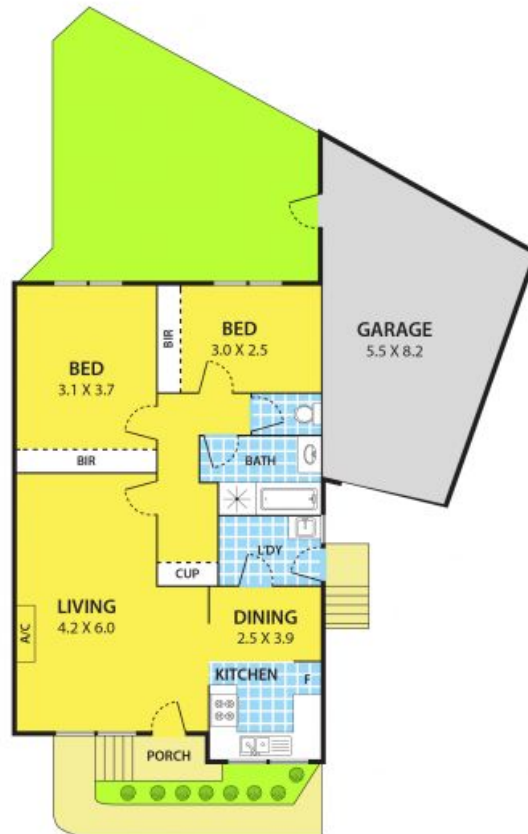

**DISCLAIMER:**

Please note plans are indicative only and not drawn to exact scale.  
All dimensions are approximate