



171 Noble Street NOBLE PARK

 4  2  4

Double Storey on Noble

This 4 years young brick veneer home could be yours, located in an excellent pocket of Noble Park, right on the border of Springvale South. Offering an impressive 25.5 Squares of two story level design with low maintenance living. Only minutes' drive to Parkmore and Mackay Shopping Centres and not at all far away from Temples, Churches, Primary and Heatherhill Secondary Schools. Easy access to Athol, Corrigan and Springvale Roads.

Featuring:

- 4 good sized bedrooms with BIRs, master with own WIR and full ensuite
- Spacious lounge
- 2 bathrooms and 3 toilets
- Open plan kitchen with gas appliances which opens to dining area
- Ducted heating & evaporative cooling
- Guest powder room
- Automatic double lock-up garage
- Fully Fenced
- Roller shutters
- Front porch and alfresco at rear

Leyton Real Estate

171 Noble Street, NOBLE PARK

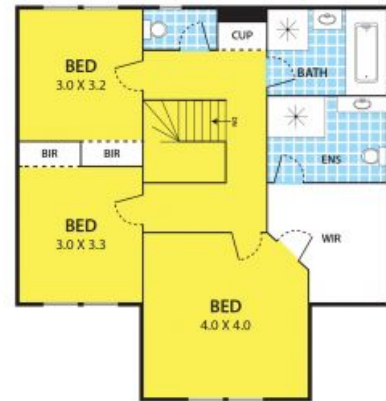

DISCLAIMER:

Please note plans are indicative only and not drawn to exact scale.
All dimensions are approximate