



20 Gordon Street NOBLE PARK

 4
  2
  3

IS YOUR FAMILY GROWING? - Up for Auction, if not sold prior.

Comprising four bedrooms, two bathrooms plus bungalow, this cream brick classic represents a fantastic opportunity for a growing family or investor. Perfect opportunity to put in your own taste and touch to it.

Central to Douglas Street shopping precinct, Noble Park train station, primary schools and secondary college, while easy access to Keysborough Secondary College (Acacia Campus), Parkmore Shopping Centre and major roads, including Chandler Road, Cheltenham Road, Heatherton Road and the Princes Highway, strengthens its appeal.

Property features:

- Two separate living spaces
- Choice of two kitchens
- Four bedrooms plus bungalow
- Built-in-robies, two bathrooms
- Solar electricity, roller shutters
- Timber floorboards, single garage

Auction: Saturday, 26 October at 1PM - if not sold prior



E Sha Hat

20 Gordon Street, NOBLE PARK

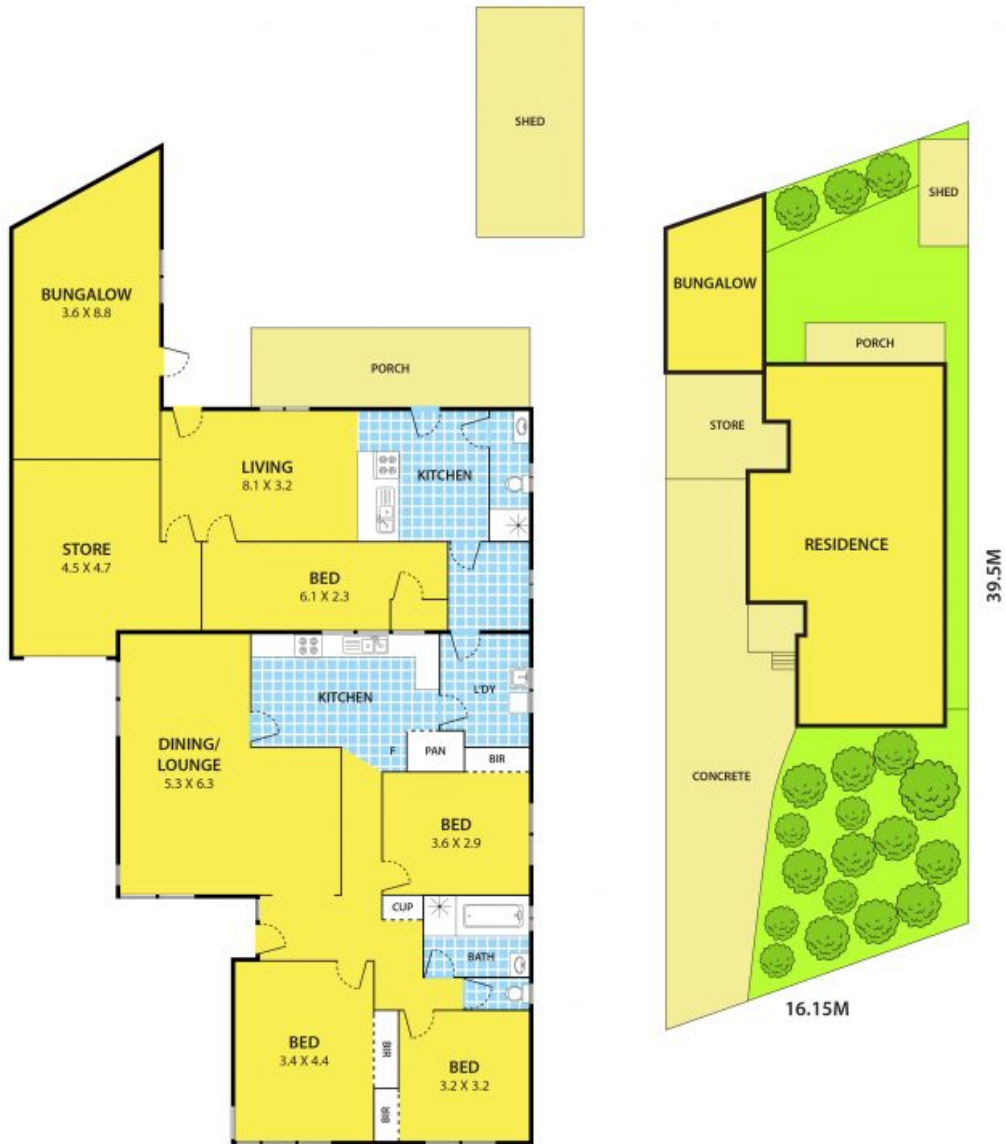

DISCLAIMER:

Please note plans are indicative only and not drawn to exact scale.
All dimensions are approximate