



4/27 Leonard Avenue NOBLE PARK

 3
  2
  1

## Modern, Easy Living Style in the Heart of Noble Park

Designed for modern lifestyles, this smartly appointed three bedroom, two bathroom residence combines stylish finishes with practical design. Set in a location that delivers unrivalled city convenience, it's certain to impress family homebuyers and investors alike searching for a low maintenance, yet spacious, home to live in or lease out.

Walking distance to Noble Park train station, Noble Park shopping centre, primary schools, cafés, restaurants, specialty stores and supermarkets. As well as easy access to secondary schools, medical clinics, parks, community hubs, Ross Reserve, Noble Park Aquatic Centre, buses and main roads, including Princes Hwy.

### Property features:

- Bright open living, dining spaces
- Modern kitchen, quality inclusions
- Private ensuite master bedroom
- Bathroom to match, built-in-robos
- Easy care gardens, rainwater tank
- Secure lockup carport and storage shed



**Kosal Prum**

0423 610 870

## 4/27 Leonard Avenue, NOBLE PARK

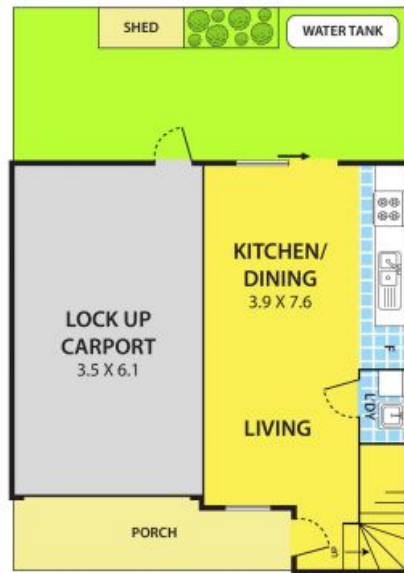

GROUND FLOOR

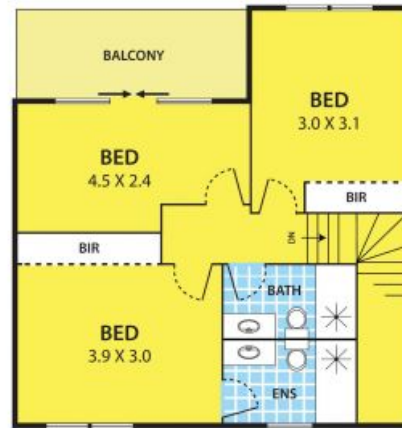

FIRST FLOOR



**DISCLAIMER:**

Please note plans are indicative only and not drawn to exact scale.  
All dimensions are approximate