



16.6m  
(approx.)

leyton



49 McWilliam Street SPRINGVALE

3 1 2

## Stunning family classic absolutely packed with potential

Nestled in a leafy pocket of fast-growing and increasingly popular Springvale, this spacious and beautifully presented three bedroom family classic boasting a sizeable block, approx. 626sqm, will prove to be a winner for motivated family owner occupiers, renovators and investors/developers alike Subject To Council Approval (STCA). Immaculate inside and out, with a perfect fusion of indoor/outdoor living, modern style and light filled spaces, this home delivers exceptional appeal.

Convenient everyday living is assured, with a number of popular amenities within a simple stroll, including Wellington Secondary College, Albany Rise Primary School, Springvale Rise Primary School, Waverley Montessori Early Learning Centre, Ouson Plaza, Waverley Gardens Shopping Centre, Edinburgh Reserve Playground and local bus services. You're also 10 minutes or less away from Springvale Shopping Centre, Springvale Station, Sandown Racecourse and Entertainment Centre, Monash University, Monash Medical Centre, M-City, the Princes Highway, Monash Freeway and Eastlink.



**Kosal Prum**

0423 610 870

49 McWilliam Street, SPRINGVALE

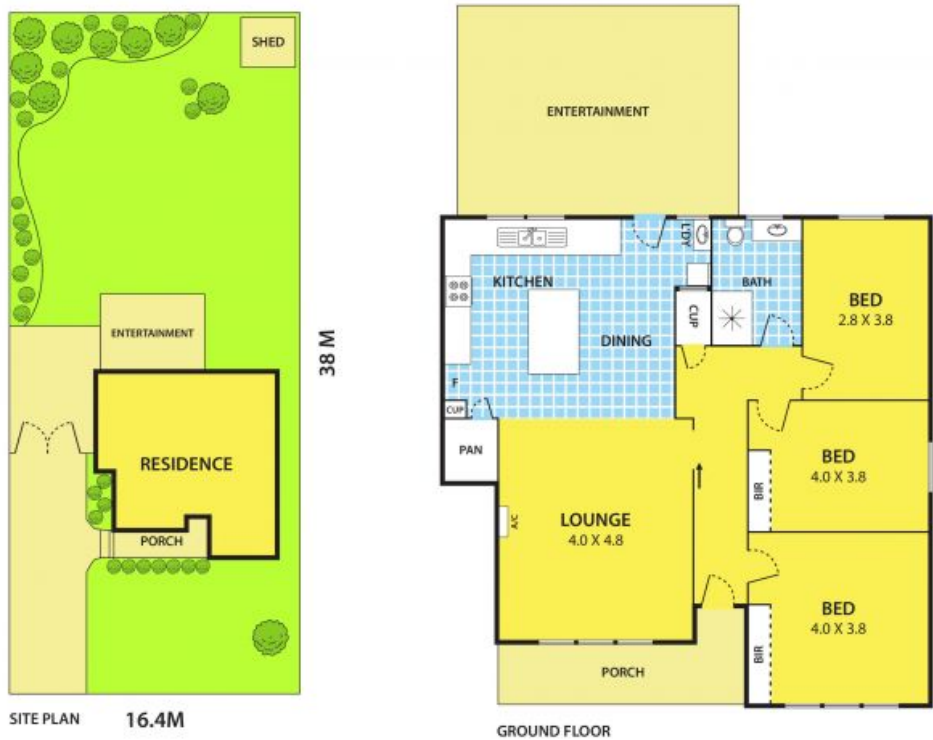

DISCLAIMER:  
Please note plans are indicative only and not drawn to exact scale.  
All dimensions are approximate