

2/5 Parsons Avenue SPRINGVALE

 2
  2
  1

Sleek modern design, stress free convenient lifestyle

Contemporary, convenient and carefree, this bright two bedroom, two ensuite bathroom townhouse would make a smart addition to a blue-chip investor's portfolio. Alternatively, market entrants and young families will feel right at home in this easy to maintain abode featuring modern comforts, quality finishes and clever design.

Positioned for lifestyle, it's walking distance to shops, caf?s, buses and parklands. Nearby are schools, including Minaret College, Springvale Rise Primary, Wellington Secondary College and St John Vianney's School, Springvale Shopping Centre, Homemaker Centre, Monash University, Sandown Racecourse, Springvale Station and the CBD (approx. 30kms).

Property features:

- Generously proportioned lounge room
- Stone bench, 2-Pac kitchen/dining zone
- European stainless steel appliances, pantry
- Private balcony, low maintenance courtyard
- Well-scaled bedrooms/WIRS, modern ensuites



Kosal Prum

0423 610 870

2/5 Parsons Avenue, SPRINGVALE

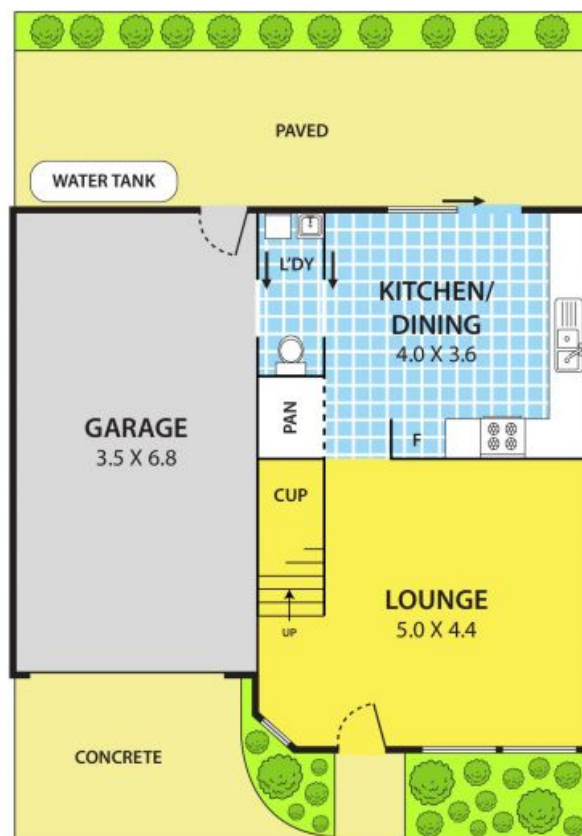
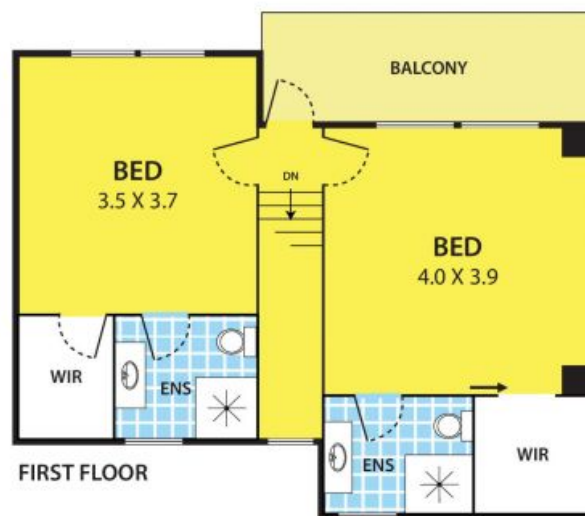

GROUND FLOOR