



1/52 Fintonia Road NOBLE PARK

 3
  1
  2

Boutique modern living in a family focused area

Enjoying a prime front position in a boutique group of four, this impressive three bedroom plus study town residence has been cleverly designed for modern living. Combining well-scaled indoor/outdoor spaces with easy-care surrounds, it offers huge lifestyle and investment appeal.

Quiet and convenient, this stylish home is well-placed in the Harrisfield Primary School and Noble Park Secondary College school zones, near Noble Park shopping, dining precinct, Dandenong Plaza, Waverley Gardens, Parkfield Reserve, buses, trains, the Princes Highway and Eastlink.

Property features:

- Open plan living room, separate study
- Large undercover entertaining zone
- Stone finished kitchen, dining area
- Stainless steel appliances, downlights
- Carpeted bedrooms, built-ins, blinds
- Modern family bathroom and laundry
- Powder room, easy-care tiled floors
- Split-system air conditioners, storage

Leyton Real Estate Pty

1/52 Fintonia Road, NOBLE PARK

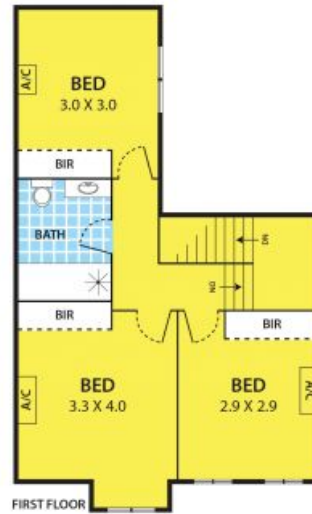

DISCLAIMER:

Please note plans are indicative only and not drawn to exact scale.
All dimensions are approximate