



28 Jessie Street NOBLE PARK

 3  1  3

Invest Or Occupy!

This corner block rendered BV home set on a rectangular block of 543m² and close to all amenities. Central to Douglas Street shopping precinct, Noble Park train station, Primary schools and Secondary college, while easy access to Keysborough Secondary College (Acacia Campus), Parkmore Shopping Centre and major roads, including Chandler Road, Cheltenham Road, Heatherton Road and the Princes Highway, strengthens its appeal.

Features: formal lounge, 3 spacious bedrooms with 1 BIR, a sunroom, main bathroom with extra toilet, separate toilets, 2 split air conditionings, timber floor, all gas appliances, locked up 1 car carport, big backyard for kids to play and fully fenced.

Keep it for lease then subdivide later (STCA) or occupy, your choice!

Don't miss out this fantastic opportunity.

Call Thu Le 0421 903 814

Photos ID required for all Inspections.



Thu Le

0421 903 814



Nora Man

0416779452

28 Jessie Street, NOBLE PARK

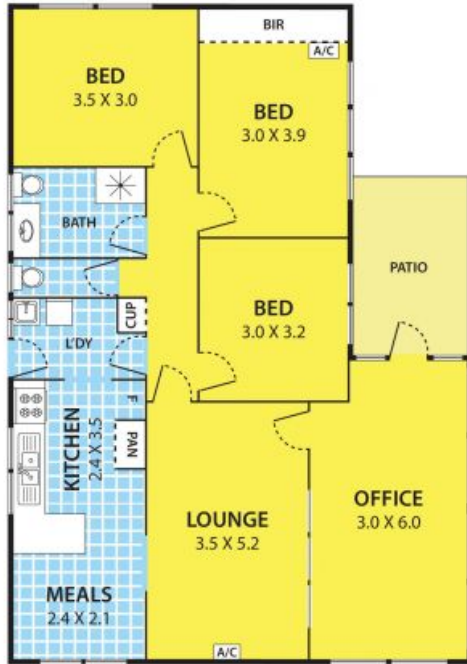

DISCLAIMER:

Please note plans are indicative only and not drawn to exact scale.
All dimensions are approximate