



6 Inner Harbour Drive PATTERSON LAKES

 3
  2
  4

Stunning Waterfront Living - Luxury at its Best!

Welcome to your dream home!

This exquisite property offers the perfect blend of style, comfort, and breathtaking lake views that only millionaires dream of. Prepare to be amazed as you step into the open plan kitchen and living area, where every moment spent is enhanced by the picturesque backdrop of the glistening lake. With downlights throughout, the ambiance is always set just right. Rear potoon for boat mooring.

Featuring three spacious bedrooms with built-in robes, this home ensures ample storage space for all your needs. The separate bathroom adds convenience and privacy for you and your guests. But the true masterpiece lies in the master bedroom, which boasts a full en-suite and a large space that opens up to mesmerizing views of the waterfront. Stay comfortable year-round with the split system air conditioning, offering the perfect climate control for any season.

The elegant timber floorboards add a touch of sophistication to every step you take, while the property's perfect positioning on the water's edge offers a sense of tranquility and exclusivity. Step outside and be greeted



Tony Le

0412 133 378

6 Inner Harbour Drive, PATTERSON LAKES



GROUND FLOOR 7.9M

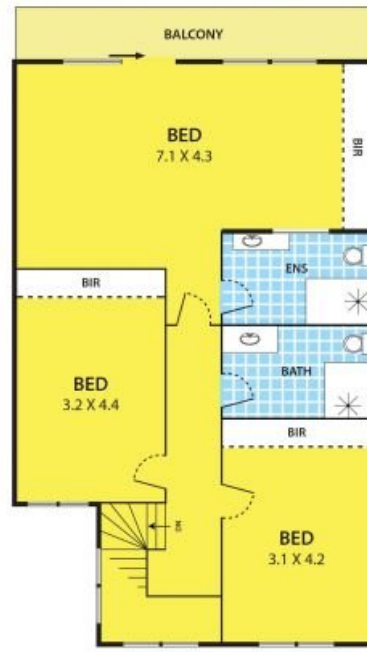

FIRST FLOOR



DISCLAIMER:

Please note plans are indicative only and not drawn to exact scale.
All dimensions are approximate