

4/27 Leonard Avenue NOBLE PARK

3 2 1

Modern, Easy Living Style in the Heart of Noble Park

Designed for modern lifestyles, this smartly appointed three-bedroom, two-bathroom residence combines stylish finishes with practical design. Set in a location that offers unrivalled city convenience, it's perfect for family homebuyers and investors alike searching for a low maintenance, yet spacious, home to live in or lease out.

Within walking distance to Noble Park train station, shopping center, schools, caf?s, restaurants, and supermarkets. As well as easy access to secondary schools, medical clinics, parks, community hubs, Ross Reserve, Noble Park Aquatic Centre, buses and main roads, including Princes Hwy.

Property features:

- Bright open living, dining spaces
- Modern kitchen, boasts quality inclusions
- Private ensuite master bedroom
- Bathroom to match, built-in-robos
- Easy care gardens, rainwater tank
- Secure remote lockup carport and storage shed

Inspect: Tuesday, 30th April 2024 4:00 - 4:30



Kosal Prum

0423 610 870

4/27 Leonard Avenue, NOBLE PARK



GROUND FLOOR

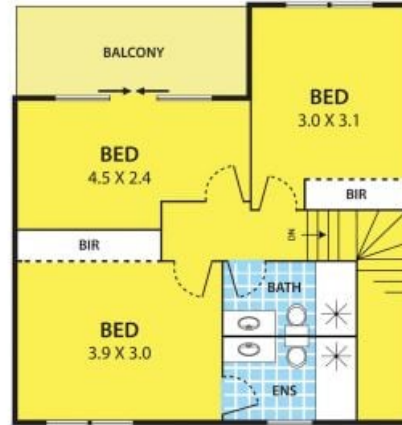

FIRST FLOOR



DISCLAIMER:

Please note plans are indicative only and not drawn to exact scale.
All dimensions are approximate