



## 16 Whitworth Avenue Springvale VIC

4 🛏 2 🚿 3 🚗

Positioned on a substantial 795m<sup>2</sup> (approx.) rectangular block, this classic red-brick home offers both comfort and opportunity.

The well-preserved four-bedroom layout provides a solid foundation for enhancements or redevelopment. With plans proposed for an 8-bedroom Rooming House, (no town planning require), the possibilities are endless-whether you're envisioning a dream home or a multi-dwelling project subject to council approval (STCA).

Current features include a formal living area, a spacious kitchen with ample storage, a sun-drenched dining area, four generously-sized bedrooms (two with built-in robes), two bathrooms (one with a combined laundry), a separate

**Type** : House  
**Price** : \$1,090,000  
**Land Size** : 795 sqm  
**View** : <https://www.leytonre.com.au/8120367>



**Thu Le**  
03 9547 0345



**Kosal Prum**  
0423 610 870

[For full version visit the website](https://www.leytonre.com.au)

# 16 Whitworth Avenue, SPRINGVALE

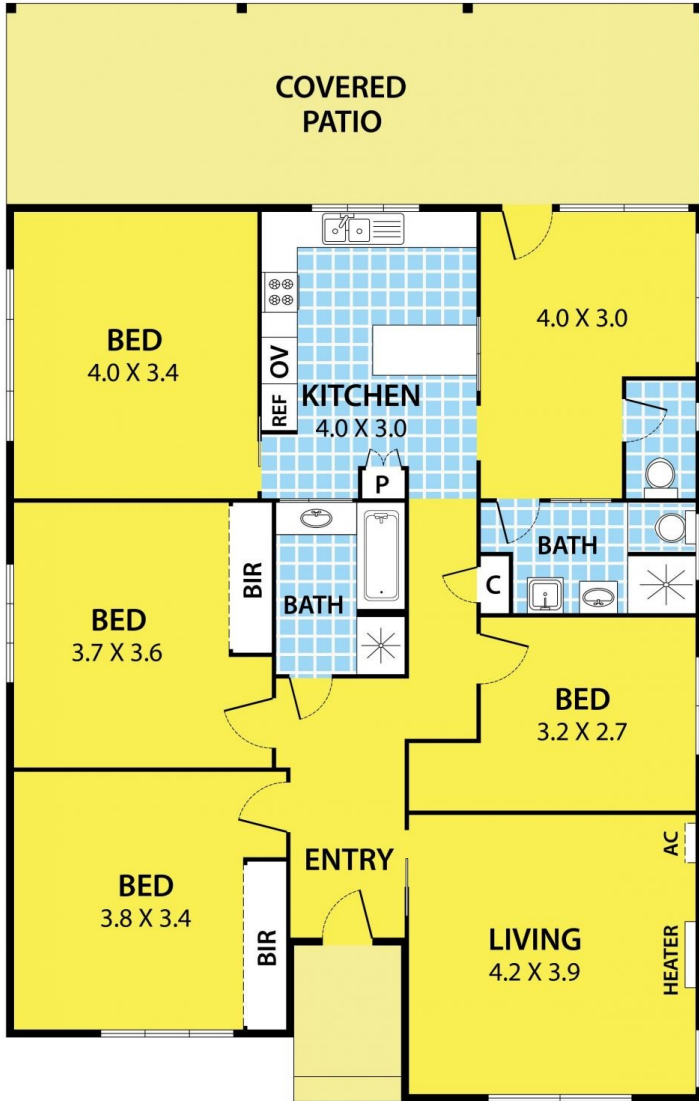

FLOOR PLAN

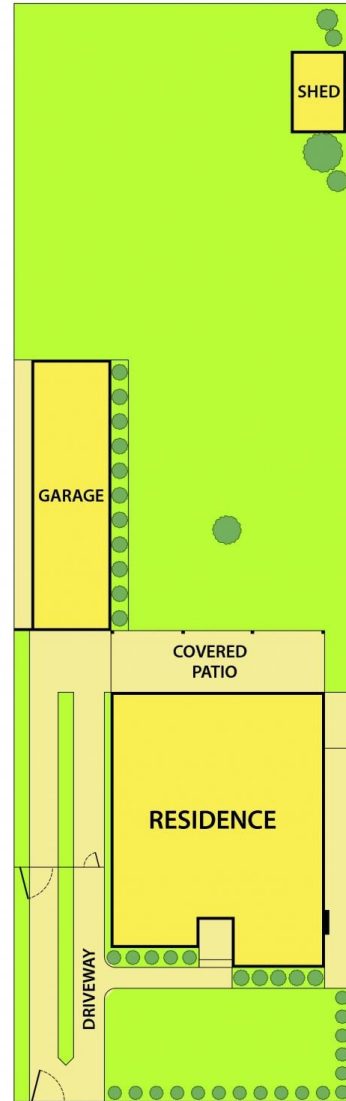

SITE PLAN



DISCLAIMER:

Please note plans are indicative only and not drawn to exact scale.  
All dimensions are approximate