

leyton[®]



612/868 Blackburn Road Clayton VIC

2  2  1 

Experience the perfect blend of residential comfort, retail convenience, and commercial vibrancy at M-City-a self-contained urban sanctuary with a welcoming local charm. Situated on Level 6 of Tower 1, this East-facing apartment offers sophisticated living with a contemporary design, a spacious layout, and premium finishes.

Enjoy unparalleled access to resort-style amenities, including: outdoor swimming pool, tennis court, BBQ area, landscaped gardens, fitness centre, child-care facilities, medical centre and pharmacy, continental grocers, fresh produce stores, restaurants, cafes, Woolworths, K-Mart, and Cinemas Village.

This apartment is ideal for first-home buyers, investors, or

[For full version visit the website](https://www.leytonre.com.au)

Type : Apartment
Price : \$530,000 - \$570,000-East Facing
View : <https://www.leytonre.com.au/8192900>



Thu Le
03 9547 0345



Kosal Prum
0423 610 870

<https://www.leytonre.com.au>

612/868 Blackburn Road, CLAYTON

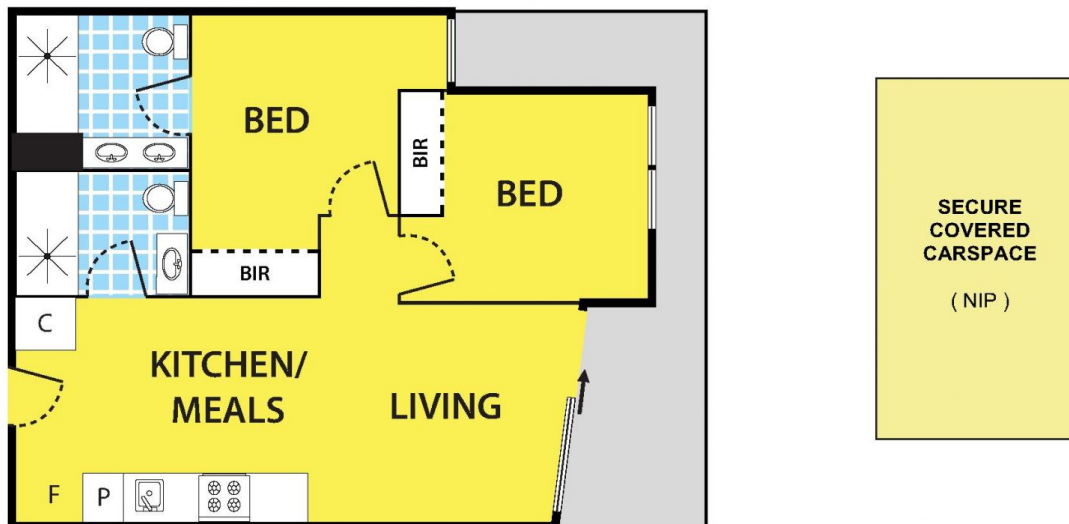

DISCLAIMER:

Please note plans are indicative only and not drawn to exact scale.
All dimensions are approximate